

GENERAL NOTES:
 IN THE 4" CONCRETE PAVED DITCHES PLACE 1/2" EXPANSION JOINT AT 30 FT INTERVALS AND AT ALL OTHER POINTS WHERE PROPOSED SWALES ABUT RIGID OBJECTS. PLACE GROOVED JOINTS 1" DEEP AT 10' INTERVALS BETWEEN EXPANSION JOINTS.
 WIDTH AND SHAPE OF PROPOSED 4" CONCRETE PAVED SWALES SHALL BE AS SHOWN OR AS DIRECTED BY TOWN REPRESENTATIVE.
 ALL CONCRETE TO BE 3600 P.S.I. COMPRESSIVE STRENGTH.

SLOPE DRAIN, BASE DITCH OR BERM DRAINAGE
 OUTLET SWALE

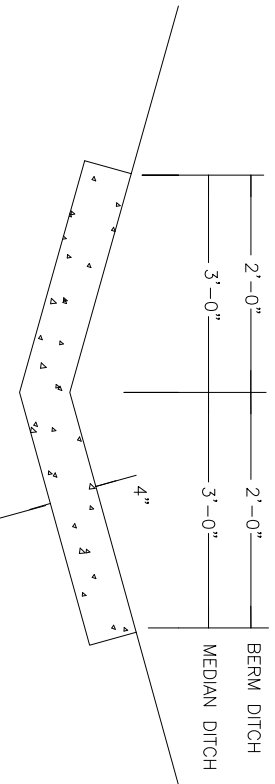

MEDIAN OR BERM SWALE

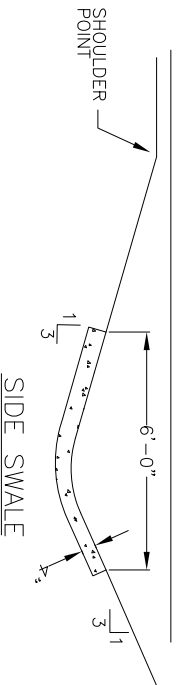

SIDE SWALE

DETAIL NOT TO SCALE

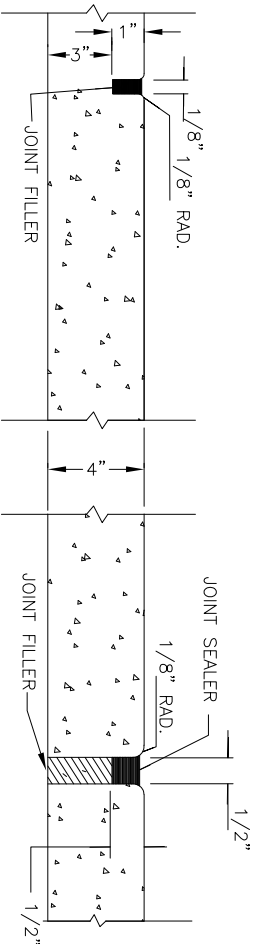

SHOWING GROOVED JOINT

SHOWING EXPANSION JOINT

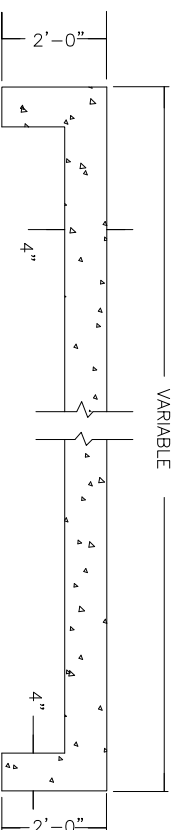

LONGITUDINAL SECTION OF PAVED SWALE

SHOWING 2'-0" CURTAIN WALL REQUIRED AT EACH END

CONCRETE PAVED SWALES
 ADOPTED FROM THE
 CITY OF CHARLOTTE

CONCRETE PAVED SWALES

STORM DRAINAGE

Detail SW-21

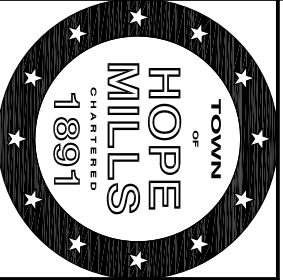

Town of Hope Mills, North Carolina

February 28, 2015 Original